



# Golden Isles Tennis Center and Park

Project Locations: 100 Egret Dr. / 424 Layne Blvd



Project Description: The Tennis Center will consist of 5 Acres which will include tennis courts, clay and hard courts, sports lighting, site parking, Pro shop with office, restrooms, storage and concession building, bocce ball courts. Golden Isles Park will have 2 Basketball Courts, 2 bocce ball courts, playground, passive open space, picnic shelters, shade structure and walking/exercise trail. The Tennis Center and Golden Isles Park will be two separate parks designed together that will share a common architectural theme.

ENGINEER/ARCHITECT

ACAI Associates

CONSTRUCTION MANAGER

Burkhardt Construction, Inc.

**PROJECT PROGRESS APRIL 2019**

- City Commission has approved a new site plan for the Golden Isles Tennis Center and Park
- Contractor is reviewing the revised plan to update the GMP
- Final GMP approval and contract award is set for May commission meeting

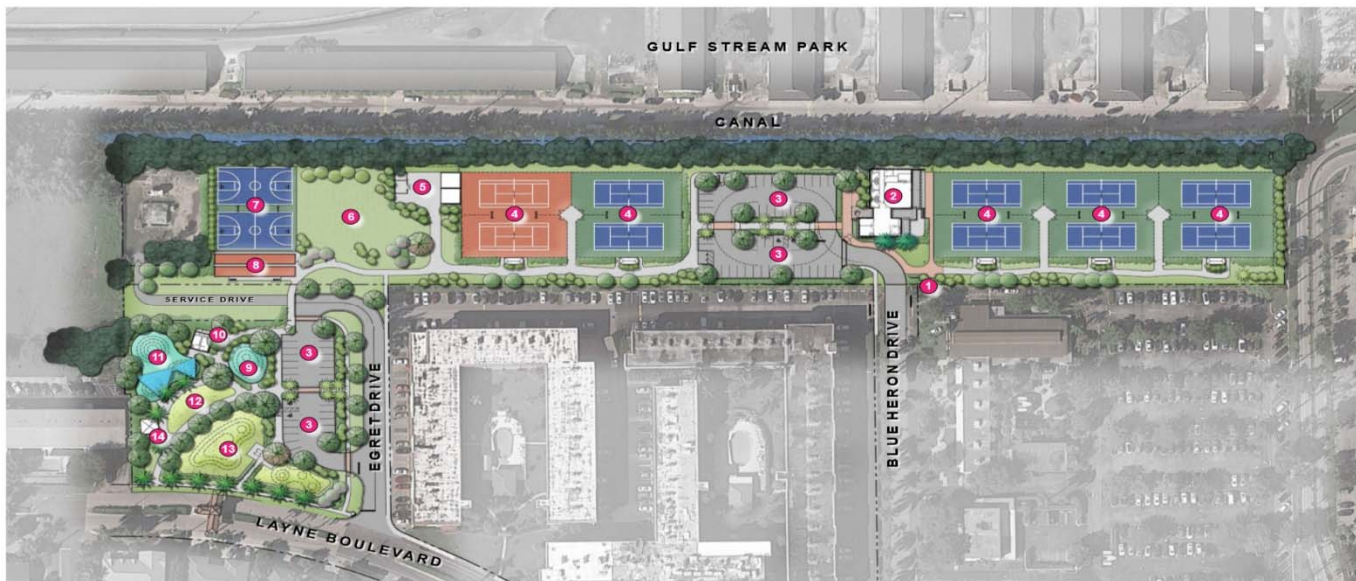

- LEGEND:**
1. MONUMENT SIGN
  2. TENNIS CENTER
  3. PARKING
  4. TENNIS COURTS (10)
  5. MATERIALS STORAGE
  6. RETENTION AREA
  7. BASKETBALL COURTS (2)
  8. BOCCY BALL (2)
  9. FITNESS AREA
  10. RESTROOM BUILDING
  11. PLAYGROUND
  12. OPEN LAWN
  13. DOG PARK (LARGE & SMALL DOGS)
  14. PAVILION

**TENTATIVE WORK SCHEDULE**

15% Design	May-2017
60% Construction Drawings	May-2018
Permitting	In-progress
Groundbreaking	TBD

CITY OF HALLANDALE BEACH – OFFICE OF CAPITAL IMPROVEMENT

CONTACT INFORMATION:

**Capital Projects Manager**

**Gregg Harris**

**(954) 457-3029**

[gharris@CoHB.org](mailto:gharris@CoHB.org)